

# Aeropulse Installation Guide

## Step 1

Insert the sensor or battery capsule at a 30-degree angle into the designated slot. Once aligned, press down on the top side of the capsule to secure it in place.

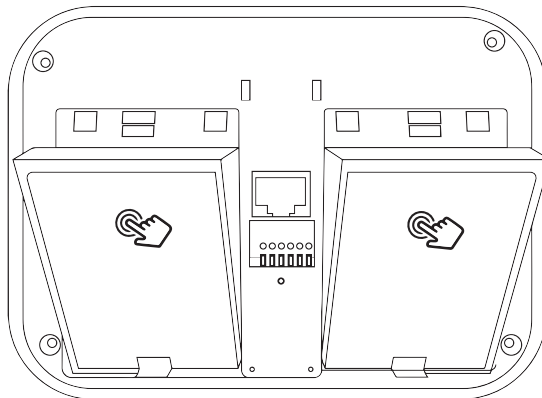

## Step 2

Position the cover over the capsules and press down firmly on the upper part to ensure a secure fit.

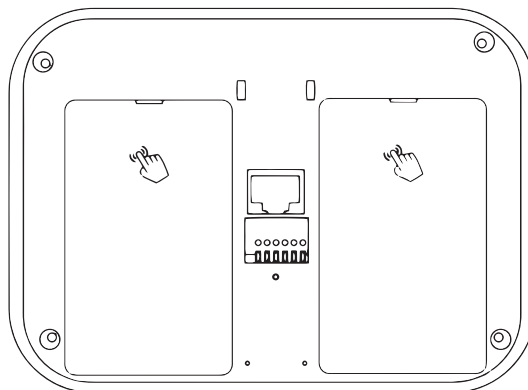

## Step 3

Attach the small bracket onto the device and secure it using three screws.

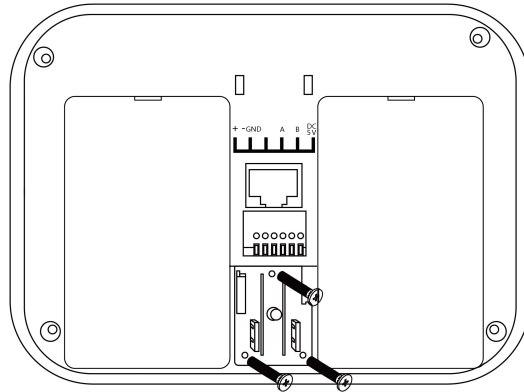

## Step 4

Mount the larger bracket onto the wall and secure it with screws

EU / CHN	US
A line drawing of a larger rectangular bracket with rounded corners. It has two circular mounting holes on the left side and two on the right side. Two screws are shown being inserted into the holes, indicated by arrows and the number 4.	A line drawing of a larger rectangular bracket with rounded corners. It has two circular mounting holes on the left side and two on the right side. Two screws are shown being inserted into the holes, indicated by arrows and the number 4.

## Step 5

Connect the necessary power and connectivity cables:

### ● Power Cable

- ☐ Connect 10-30V DC or 24V AC to the +/- terminals on the connectivity port.
- ☐ For PoE, connect to the Ethernet port

### ● Connectivity Cables

- ☐ Connect Modbus or Bacnet cables to the A/B terminals on the connectivity port.
- ☐ Connect the Ethernet cable to the Ethernet port.

## Step 6

Slide the device vertically into the wall-mounted brackets until securely positioned.

